

**NEW &
IMPROVED!**

Smart-LocTM

Multi-Diameter Fittings

FITS ALL 1/2"
Polyethylene Tubing

16, 17, and 18mm (0.620" - 0.710" OD)

**Easier & Faster To
Install Than An
Insert Fitting**

**Secure Leak
Free Connections**

Removable and Re-usable

**Replaces 600, 700 and 710
Series Compression Fittings**

**Works with AGRIFIM
Dura Flo Dripperline
and AGRIFIM A620, A660, A700,
A710 Supply Tubing**



EASY ON THE HANDS



SMART-LOC™ FITTINGS

CMAP 75 - 18:
3/4" Male Pipe Thread Adaptor



CEP 18:
End Plug



CMAH 18:
Male Hose Thread Adaptor



CMAP 5 - 18:
1/2" Male Pipe Thread Adaptor



SLC 18:
Coupling



CEL 18:
Elbow



CSA 18:
Swivel Adaptor
Female Hose Thread



CT 18:
Tee



DARE TO COMPARE

For a **FREE SAMPLE PACK** Visit:
ndspro.com/agrifim/duraflo-check-valve

	Agrifim	Rain Bird	Advantages of Agrifim vs. Rain Bird
Universal Fits all 1/2" Drip tubing	✓		<ul style="list-style-type: none"> Agrifim Smart Loc fits 16, 17 and 18mm (0.620" – 0.710" OD) PE tubing Rain Bird Easy fit only fits (0.630" – 0.669" OD) PE tubing
Re-useable	✓		<ul style="list-style-type: none"> Tubing can be inserted and removed without damage to the Smart loc fitting Rain Bird Easy fit can only be used one time
All fittings are complete functioning units	✓		<ul style="list-style-type: none"> Agrifim Smart Loc fittings are complete functioning individual units Rain Bird Easy fit requires a series of adapters that have to be snapped into main fittings creating permanent connections
Secure leak free connections every time	✓		<ul style="list-style-type: none"> Agrifim Smart loc progressive compression design ensures leak free connections every time Rain Bird Easy fit design can lead to improper installation and leaks
Fast and easy to install	✓		<ul style="list-style-type: none"> Agrifim Smart loc design makes them quick and easy to install Rain Bird fitting is limited in tubing size and adapters make them complicated to install

INSTALLATION

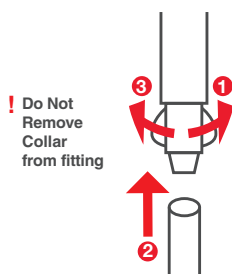

1. Expose the tapered end of the adaptor by rotating the collar all the way up the thread.
2. Using force, insert tubing onto tapered end.
3. Twist collar over the tubing to secure in place.

Part Number	Amount per Bag	List Price
SLC 18	25	\$0.89
CEL 18	25	\$1.45
CT 18	25	\$1.83
CSA 18	25	\$1.76
CEP 18	25	\$1.38
CMAH 18	25	\$0.98
CMAP 5 - 18	25	\$0.98
CMAP 75 - 18	25	\$0.98

