

## 13" x 24" PRO-SPEC™ VALVE BOXES

Series: Pro-Spec™ Series

Box Material: HDPE

Cover Material: HDPE

Box Weight: 16.85 lbs

Lid Weight: 7.85 lbs

Total Weight: 24.70 lbs

Load rating:

Pedestrian & lawn care equipment

Includes 2 x stainless steel bolts and zinc washers

Box includes 3/8-16 brass nuts

**Made in USA**

**Made from 100% recycled materials**

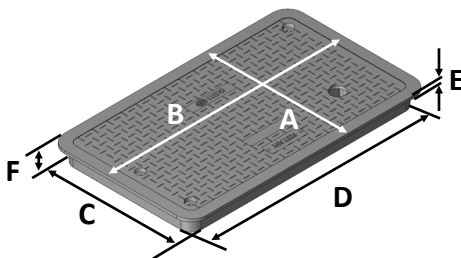

Lid Dimensions	
A. Top width	15 1/8"
B. Top length	24 3/4"
C. Bottom width	13 9/16"
D. Bottom length	23"
E. Rim thickness	0.35"
F. Overall height	2 1/4"

Box Dimensions	
A. Top inside width	13 7/8"
B. Top inside length	23 3/8"
C. Top outside width	16"
D. Top outside length	25 1/2"
E. Bottom inside width	19 1/2"
F. Bottom inside length	29 1/8"
G. Bottom outside width	22 5/8"
H. Bottom outside length	32 1/4"
I. Height	12"

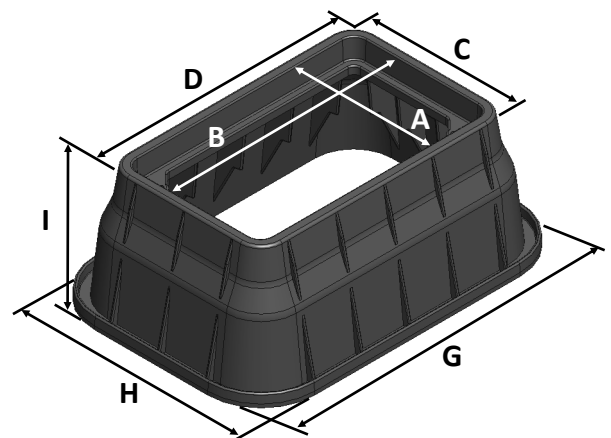

## 13" x 24" PRO-SPEC<sup>™</sup> VALVE BOXES

PART NUMBER	DESCRIPTION	BOX COLOR	COVER COLOR	COVER MARKING
BOX & COVER COMBINATIONS				
321BCB	12" TALL BOX WITH OVERLAPPING BOLT-DOWN COVER	GREEN	GREEN	ICV
321BCB-BG	12" TALL BOX WITH OVERLAPPING BOLT-DOWN COVER	BLACK	GREEN	ICV
321BCBS	12" TALL BOX WITH OVERLAPPING BOLT-DOWN COVER	GREEN	GREEN	SEWER
321BCBW	12" TALL BOX WITH OVERLAPPING BOLT-DOWN COVER	GREEN	GREEN	WATER
322BCB	15" TALL BOX WITH OVERLAPPING BOLT-DOWN COVER	GREEN	GREEN	ICV
322PBCBR	12" TALL BOX WITH OVERLAPPING BOLT-DOWN COVER	PURPLE	PURPLE	RECLAIMED WATER
325BCB	15" TALL BOX WITH OVERLAPPING BOLT-DOWN COVER	BLACK	GREEN	ICV
COVER ONLY				
322C	OVERLAPPING COVER		GREEN	ICV
322CS	OVERLAPPING COVER		GREEN	SEWER
BOX ONLY				
321B	12" TALL BOX	GREEN		
322B	15" TALL BOX	GREEN		
325B	15" TALL BOX	BLACK		
121BB	3" X 3/8" STAINLESS STEEL BOLT	STEEL		

PHYSICAL PROPERTIES OF HDPE	ASTM TEST METHOD	TEST RANGE
TENSILE STRENGTH YIELD	D-638	3,400—4,400 PSI
FELXURAL MODULUS	D-790	140,000—200,152 psi
COMPRESSIVE STRENGTH	D-695	3,340—4,600 PSI
IMPACT STRENGTH, IZOD	D-256	1.5—15 FT. LBS/IN
DUROMETER HARDNESS, TYPE D	D-2240	63-67
DEFLECTION TEMPERATURE @66PSI STRESS	D-648	150-212°F
SPECIFIC GRAVITY	D-792	0.941—0.965